



## VKX05 // for insertion installation



VKX05

### Your advantages

<b>Series</b>	<b>VKX05</b>
	<ul style="list-style-type: none"> <li>• Direct installation into pipe lines DN 50...150</li> <li>• Sealed with integrated O-ring</li> </ul>

<b>Technical data</b>	<b>VKX05</b>
<b>Switching function</b>	Contact closes at increasing flow
<b>Nominal diameter range</b>	Applicable in DN 50...150
<b>Pressure rating</b>	PN 10
<b>Temperature ranges</b>	
<b>Medium</b>	-20...100 °C
<b>Ambient</b>	-20...70 °C
<b>Electrical data</b>	
<b>Electrical connection</b>	1.5 m PVC jacket cable
<b>Degree of protection EN 60529</b>	IP65
<b>Max. Switching current</b>	Max. 1 A
<b>Max. Rating</b>	Max. 26 VA, 20 W
<b>Max. Switching voltage</b>	230 VAC, 48 VDC or 24 VAC, 42 VDC
<b>Protection class EN 60730-1</b>	Class II or Class III
<b>Approvals</b>	
  	

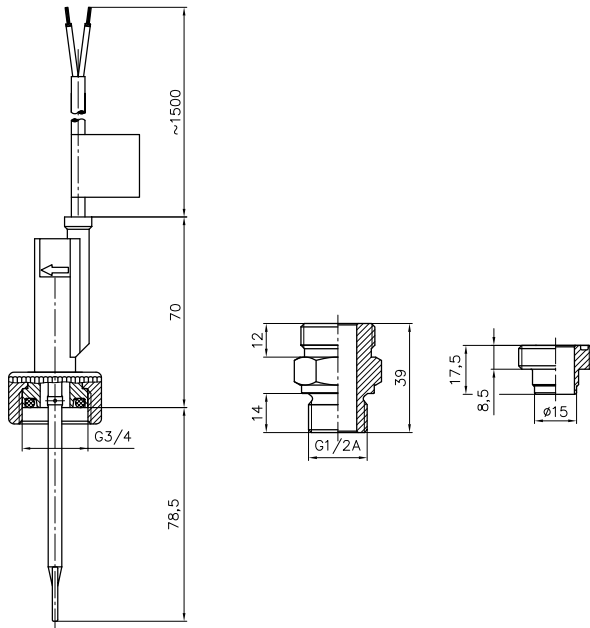

Materials in contact with fluid	
Type	VKX05
Body	PPE+PS Noryl™ 30 % glass fibre reinforced
Paddle	PPE+PS Noryl™ 30 % glass fibre reinforced
Pin	Stainless steel 1.4571 or titanium
Magnet	Hard ferrite
O-ring	EPDM
Soldering adapter	Brass CW614N
Process connection	Brass CW614N or stainless steel 1.4571

Order code			
<b>Type</b>			
VKX05	VKX05M2P2		
VKX05 with titanium pin	VKX05M2B2		
<b>Switching voltage</b>			
230 VAC, 48 VDC		AP	
24 VAC, 42 VDC		BP	
<b>Process connection</b>			
Union nut G <sup>3</sup> / <sub>4</sub>			U10
Threaded adapter G <sup>1</sup> / <sub>2</sub> brass			R21
Threaded adapter G <sup>1</sup> / <sub>2</sub> stainless steel			R23
Soldering adapter			D11
<b>Example order number</b>	<b>VKX05M2P2</b>	<b>AP</b>	<b>U10</b>